

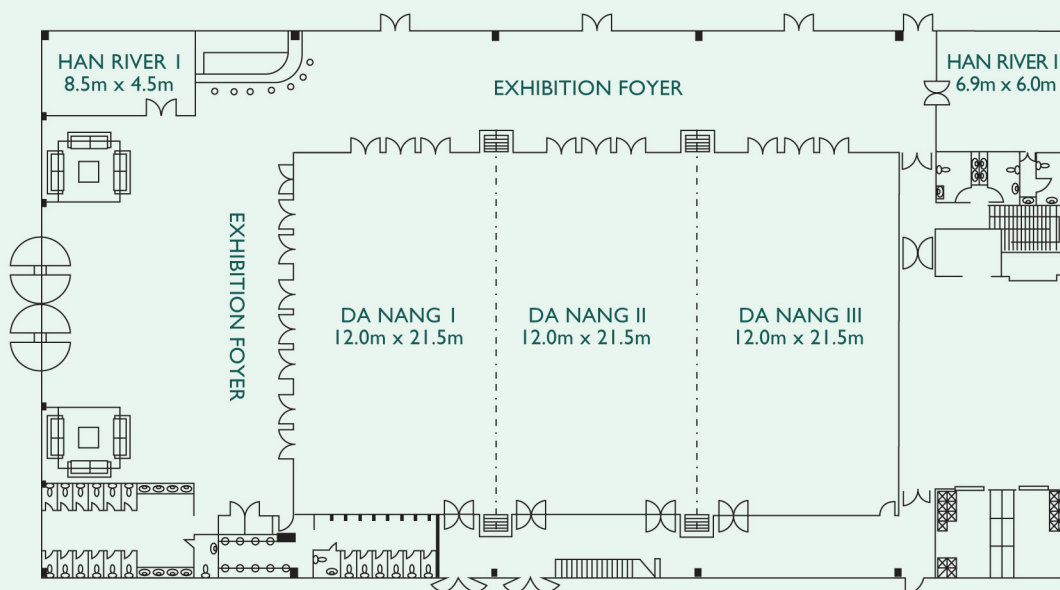

Meeting Rooms	Dimension (LxWXH) m	Area (sqm) m2	Dinner (persons)	Theatre (persons)	Classroom (persons)	U-Shape (persons)
Da Nang Gand Ballroom	21.5x36x5.5	774	550	1000	500	250
Da Nang Ballroom 1	21.5x12x5.5	258	150	250	120	70
Da Nang Ballroom 2	21.5x12x5.5	258	150	250	120	70
Da Nang Ballroom 3	21.5x12x5.5	258	150	250	120	70
Ballroom Foyer		700				
Han River Room 1	8.5x4.5x2.5	38.25	20	30	20	15
Han River Room 2	6.9x6.x2.5	41.4	25	30	20	15
Son Tra Room	9.5x6.5.x2.5	61.75	30	40	24	20
Non Nuoc Room 1	7.5x7x2.6	52.5	40	50	36	35
Non Nuoc Room 2	7.5x7x2.6	52.5	40	50	36	35
Non Nuoc Room 1 & 2	15x7x2.6	105	65	80	60	50
Ocean Ballroom	33x11x3	363	200	300	160	100
Ocean Ballroom Foyer		350				
Gallery Room 1 & 2	10x18x3.3	180	90	120	80	45
Gallery Room 3 & 4	10x18x3.3	180	90	120	80	45
Gallery Room 1	10x9x3.3	90	40	60	40	20
Gallery Room 2	10x9x3.3	90	40	60	40	20
Gallery Room 3	10x9x3.3	90	40	60	40	20
Gallery Room 4	10x9x3.3	90	40	60	40	20
Bussiness Centre Room	8.2x3.75x2.4	30.75				

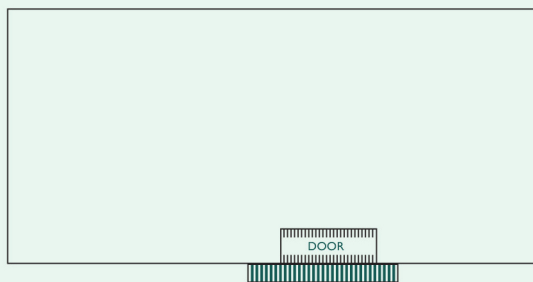

DANANG BALLROOM



HAN RIVER I
8.5m x 4.5m

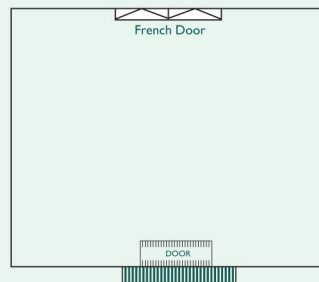

HAN RIVER II
6.9m x 6.0m

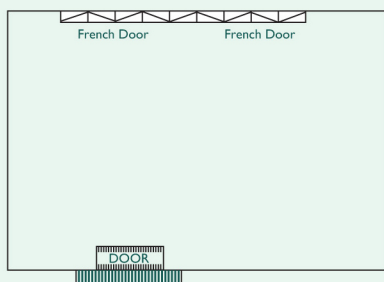

SON TRA
9.5m x 6.5m

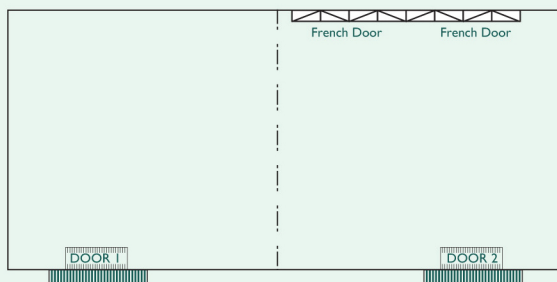

NON NUOC I & II
15.0m x 7.0m

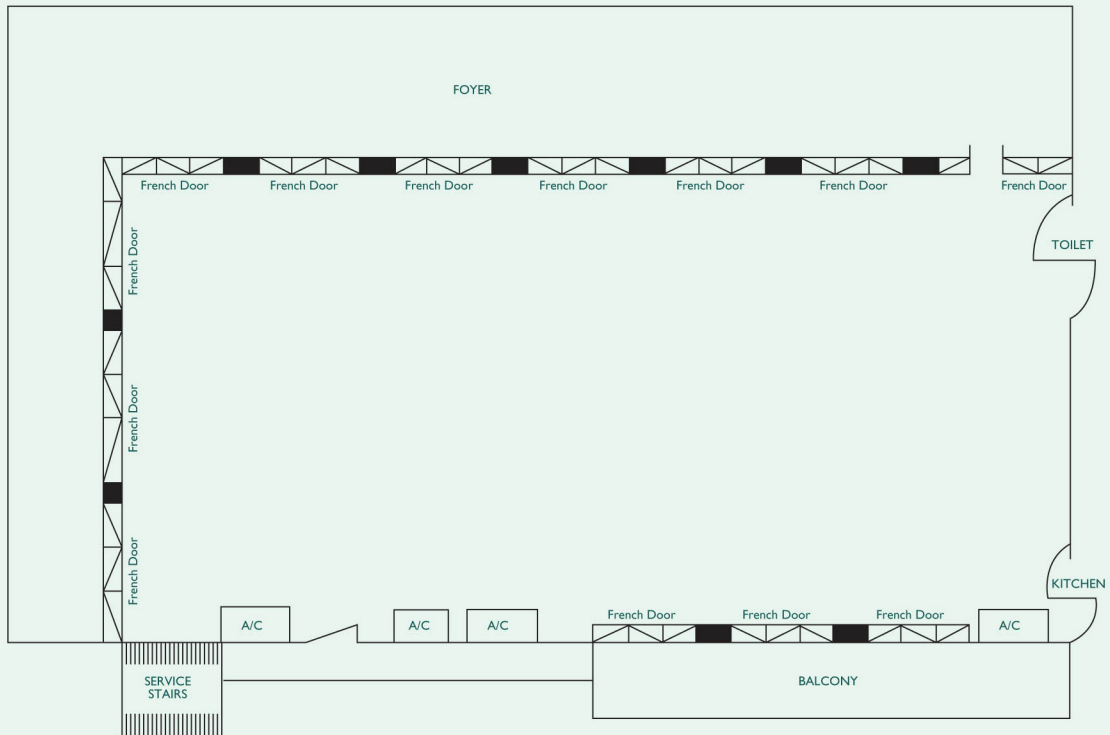

OCEAN BALLROOM
33.0m x 11.0 m

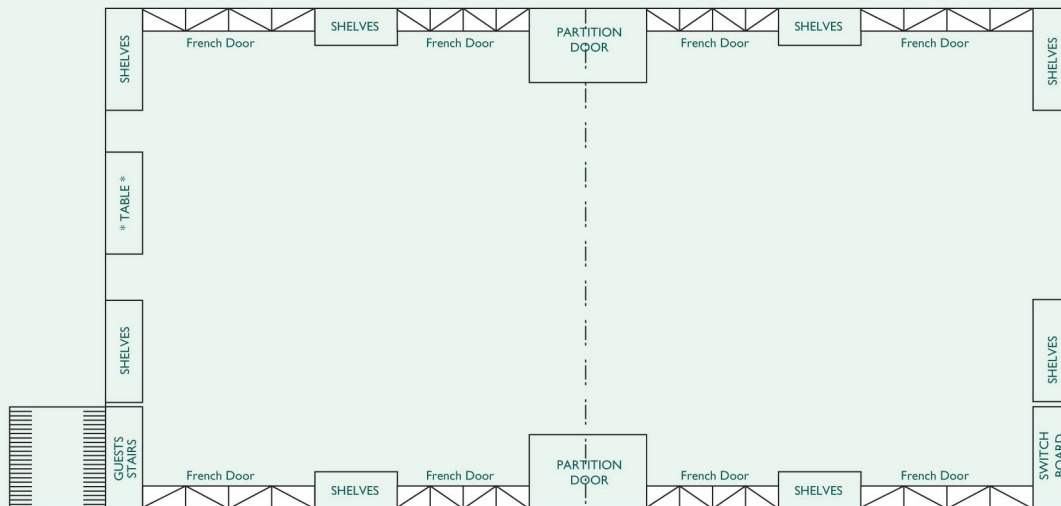

GALLERY ROOM I & II- GALLERY ROOM III & IV
18.0m x 10.0m