

HOTEL DETAILS

- 26 floors
- 164 guestrooms & suites
- 4 flexible meeting & conference rooms
- Restaurant, Bar & Lounge

GUEST SERVICES

- 24-hour in-room dining
- Concierge
- Transportation
- Car rental
- Laundry & dry cleaning
- Smoking area
- Luggage security

ACCESSIBILITY

- Lift
- Wheelchair accessibility
- Accessible room



GUESTROOM SERVICES

- In-room safe
- Air-conditioning
- Sofa
- Minibar
- Bathroom amenities
- Hair dryer
- Bathrobes
- Weight scale
- Smart TV
- International channels

SERVICES

- In-room Tea & Coffee
- Housekeeping
- Turning down service



ATTRACTIONS & DIRECTIONS

- Han Market (4km)
- Cham Museum (4km)
- Con Market (5km)
- Lady Buddha Danang (6km)
- Son Tra Peninsula (6km)
- Ngu Hanh Son (12km)
- Hoi An Ancient Town (30km)
- Hai Van Pass (30km)
- Bana Hills (46 km)

ARRIVAL INFORMATION

- Check in: 14:00
- Check out: 12:00 pm



WELLNESS & SPA

- Annona Spa
- Infinity swimming pool
- Poolside bar
- Wellness & fitness
- Himalaya salt sauna, steam bath
- Treatment
- Massages

CHILDREN

- Seats
- Kid room



SEL DE MER

HOTEL & SUITES



WEBSITE



seldemerhotelsuites.com



SEL DE MER

HOTEL & SUITES

Ideally located in the heart of beautiful My Khe Beach, indulge in magnificent view of Son Tra Peninsula, Sel de Mer Hotel & Suites sets a new standard for spacious accommodations and added value offerings associated with the brand in a contemporary boutique hotel. Enjoying the prime location, just 15 minutes from the city centre, 10 minutes to Linh Ung Pagoda and a 45 minute-drive from neighbouring Hoi An, Sel de Mer Hotel & Suites is the perfect base for any visit to Da Nang.

No. 92 Vo Nguyen Giap, Man Thai Ward, Son Tra District, Danang City, Vietnam
t. (+84) 2363 - 86.82.88 | f. (+84) 2363 - 86.80.88 | seldemerhotelsuites.com



RESTAURANT & BAR



JOM Bar & Lounge

- Lobby area
- 07:00 - 20:00

BAKERY SHOP (10:00 - 19:00)

- To-go pastry & Bakery
- Homemade desserts



Anemoi RESTAURANT

- 2nd floor
- Breakfast/ Lunch
- Dinner buffet & Alacarte
- All day dining

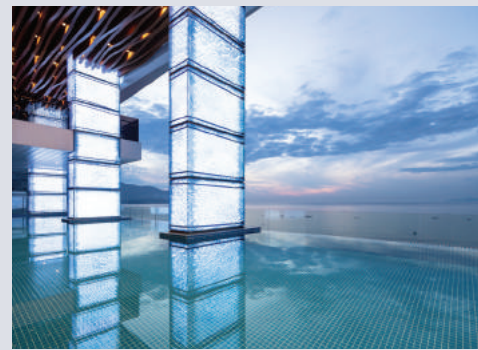

THE Speakeasy BAR & TAPAS

- Rooftop bar, 26th floor
- Draft beer/ Wine/ Cocktails/ Liqueur/ Coffee
- Tea/ Frappe/ Mocktail/ Tapas/ Western
- Homemade desserts
- 17:00 - Midnight



OVERVIEW

FUNCTION ROOM	Total Size (sq. m)	Height (m)	Banquet	Cabaret	Theater	Boardroom	Cocktail	Classroom	U-Shape
GRAND LA RIVIÈRE	175 (7 x 25)	3.5	140	96	170	60	170	100	111
LA RIVIÈRE	56 (7 x 8)	3.5	50	32	60	30	50	40	39
LA CIEL	56 (7 x 8)	3.5	30	24	50	24	40	30	27
L' OcéAN	56 (7 x 8)	3.5	30	24	50	24	40	30	27
LA VAGUE	56 (7 x 8)	3.5	30	24	50	24	40	30	27
ROOFTOP	270 (10 x 27)	-	80	-	-	-	-	-	-

CLASS ROOM

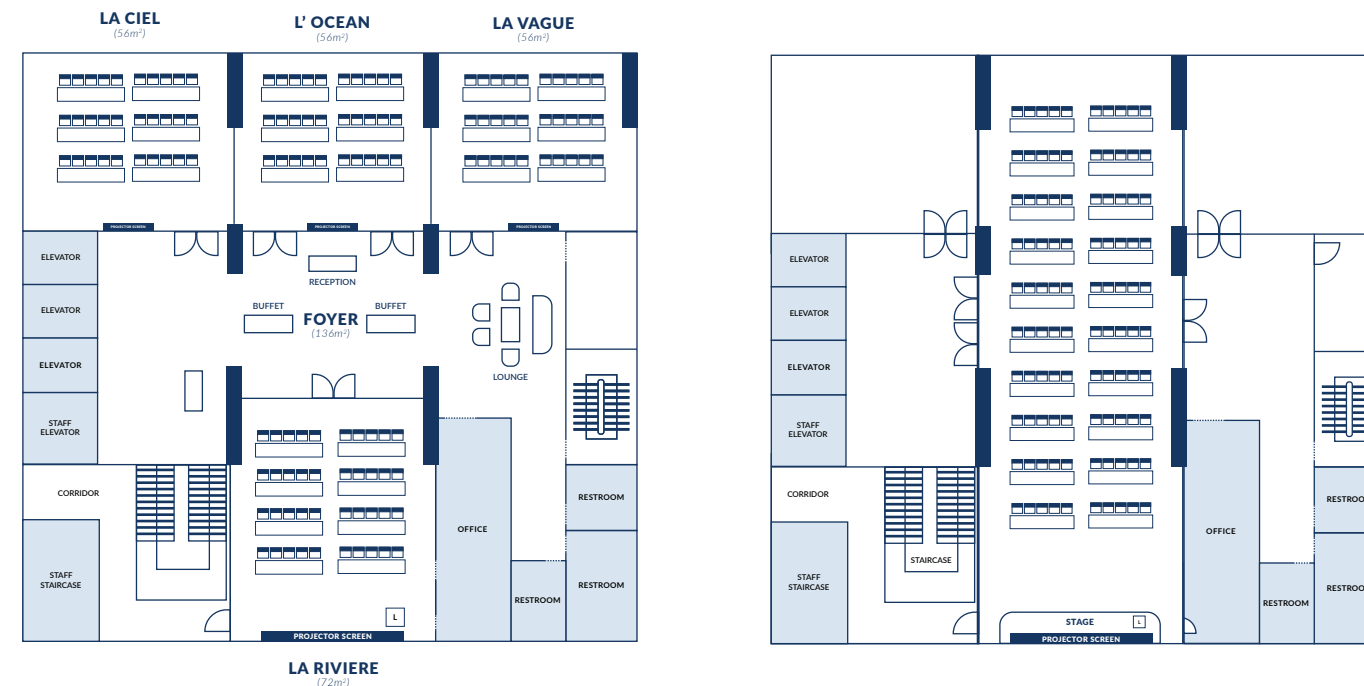

U-SHAPE

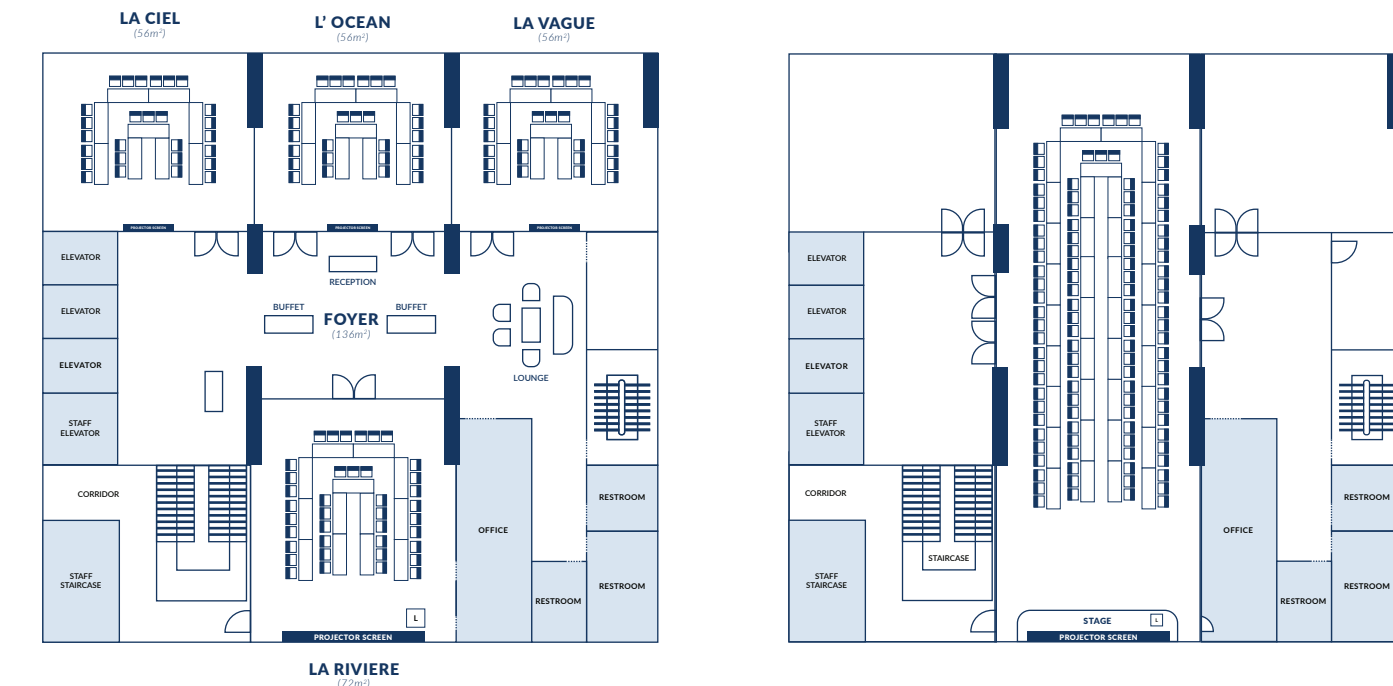

BANQUET



THEATER

