

DECKENIA

PRASLIN - SEYCHELLES

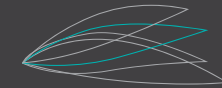

DECKENIA

Deckenia is one of the 5 endemic species of palm trees found in the "May Valley" forest in Praslin, classified as UNESCO World Heritage Site.



The promise of paradise. With the ocean in clear sight and the landscape looking like a painting, DECKENIA welcomes you to its oasis of peace and serenity. Nestled on the 'Anse Gouvernement' beach, in Praslin, Seychelles, the villa of this sumptuous property opens out on the sea and transforms itself into your shelter. Here, as the seasons pass by time stops, nature takes over, and you will forget everything else.





The enchanted islands. World renowned for its flora and fauna, its turquoise sea and its heavenly beaches, the reputation of The Seychelles is second to none. Among the hundreds of islands that form the archipelago, "Praslin" is the most famous. Symbol of serenity and harmony with nature, it is home to a myriad of endemic species, especially in its "Vallée de Mai", classified as a World Heritage Site. To the east of Praslin, the Cote d'Or beach, borders endlessly on extraordinary turquoise lagoon which does not affect in any way the serenity and peace of The Seychelles ...



colours of Seychelles

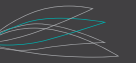



Off the beaten path. Away from curious eyes and crowds, the site offers an incomparable intimacy to those in search of relaxation without sacrificing their comfort. The permanent painting, which one can look out without ever feeling bored, which constitutes the landscape, encourages and inspires the rhythms of the soul to surrender oneself in a luxurious setting.

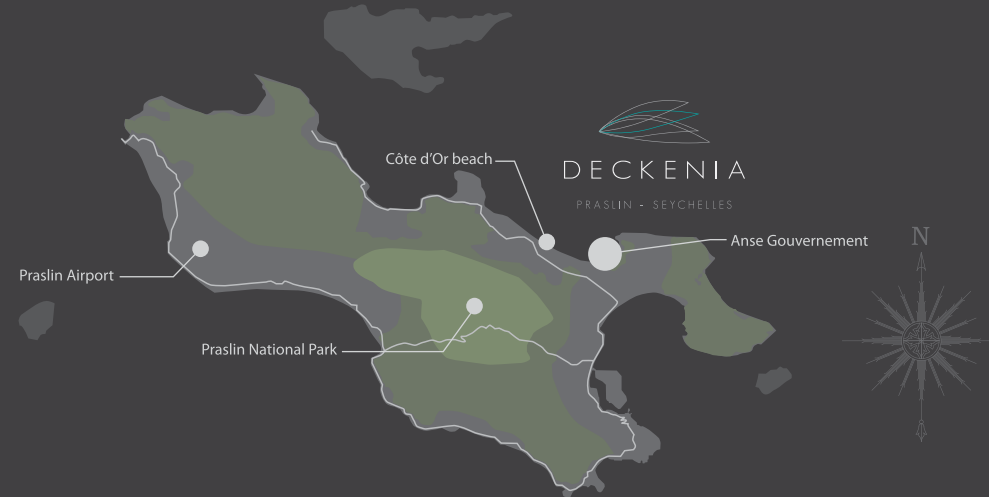

The "DECKENIA" property consists of a 5 bedrooms luxury villa with an infinity pool, two guest houses with private pool. Ideal for accommodating large families or groups of friends, the villa and guest houses offer beautiful views on the ocean.

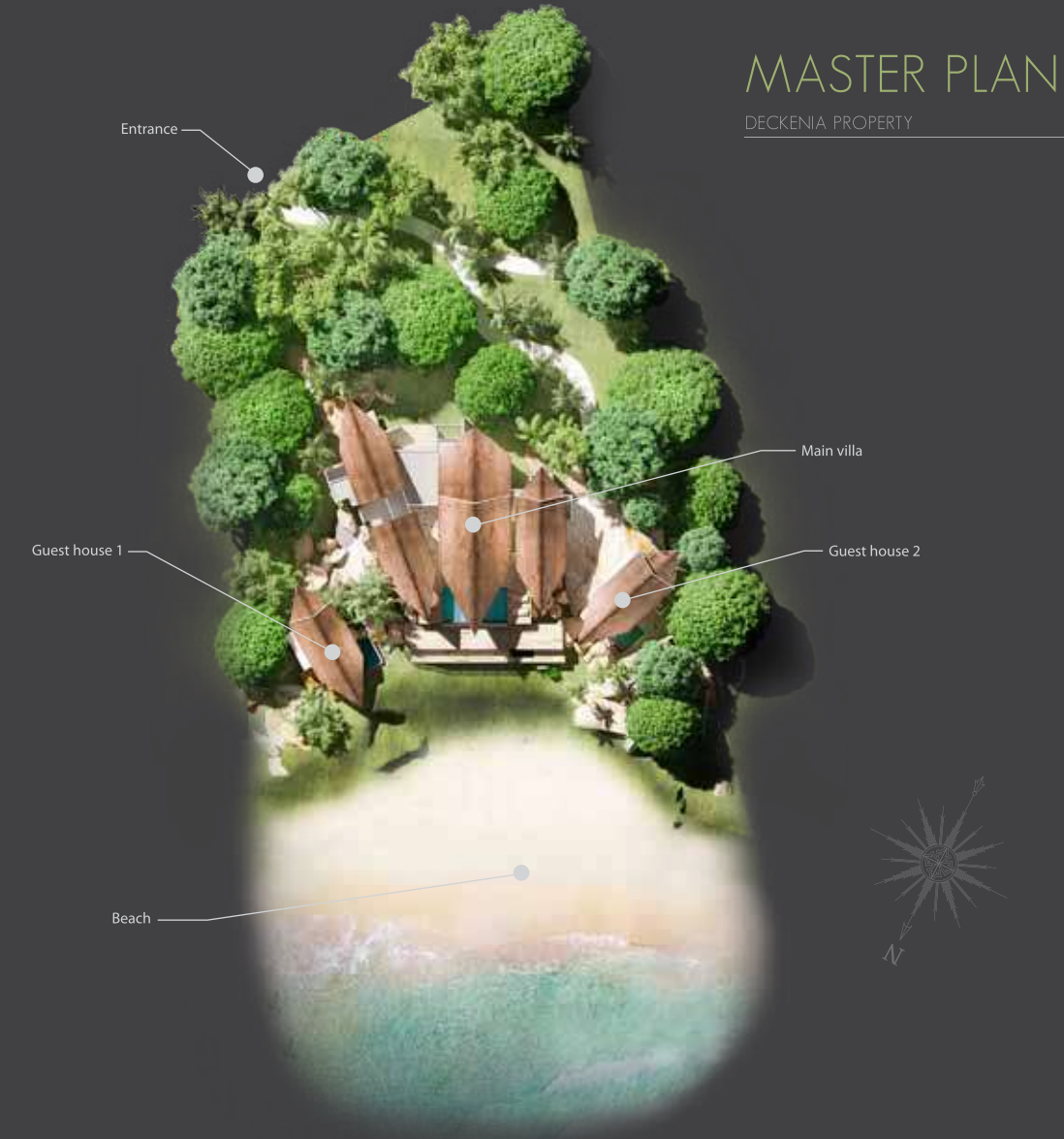

MASTER PLAN

DECKENIA PROPERTY

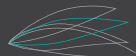



ELEGANCE,
FRESHNESS AND
SENSUALITY

THE POOL

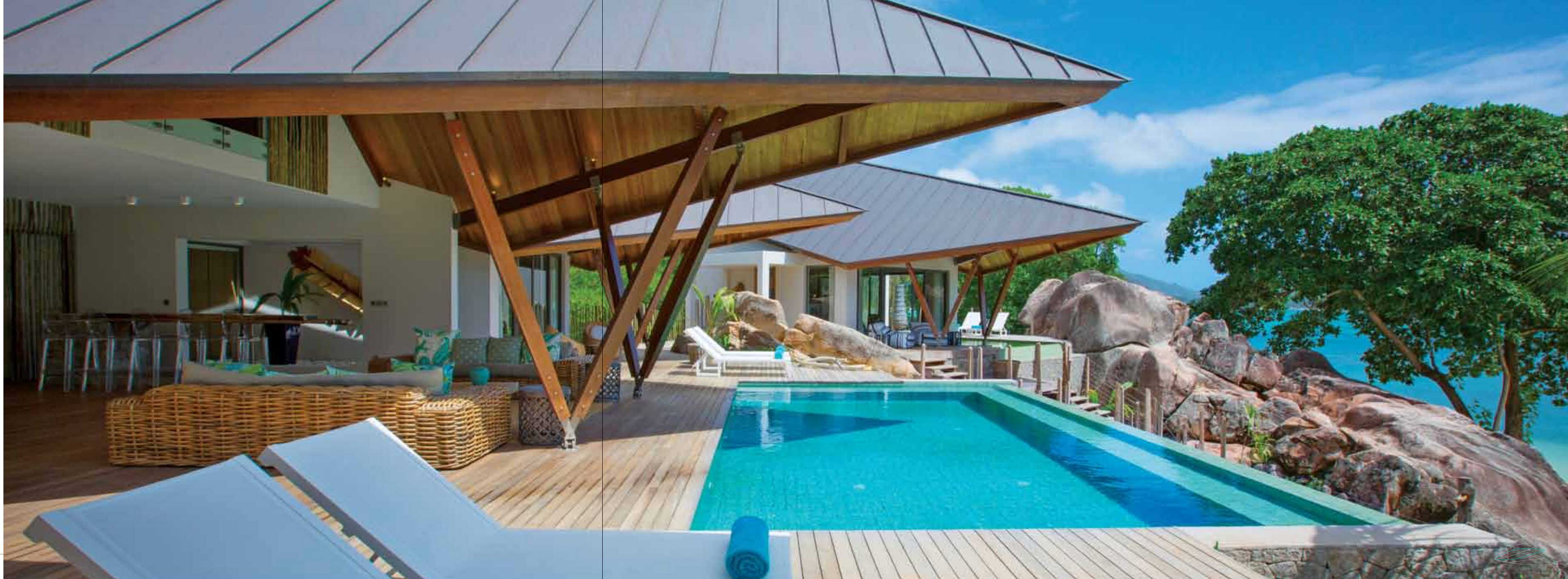



THE PLEASURE OF A SWEET LIVING

The modern architecture of the place is both luxurious and discreet. The peace of mind offered by this sleek and classy design is accentuated by the beautiful views on the Indian Ocean. Whole living spaces where one can enjoy a good book and day dream are placed here and there, so as to enjoy the coolness of the house while admiring the sea view.

While large open rooms and large terraces create the illusion of a complete immersion in nature, the light colours of the villas contrast with the intensity of blue sky and that of the sea.

BEACHFRONT

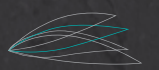

THE
HOLIDAY
SPIRIT

VERANDA



Fresh ground that incites you to walk barefoot, comfortable benches that invite relaxation, a few pieces of design chosen and outdoor furniture from which one has the greatest difficulty to move out ...

The villas are fully equipped and furnished and are only waiting for their residents to fulfil their every single desire.



CHIC GLAMOUR

The rooms, which are very spacious, are flooded with natural light from its many windows. One can move into the suite as a mini home, moving without transition from one space to another. Bathroom, bedroom and terrace to enjoy the spectacular view.

You will have only one desire, that of coming back...





ENJOY LIFE

Like a fragrance in summer, it is impossible to resist the charm of the property and all it has to offer. Space, comfort and privacy blend and merge into sumptuous furnishings to create a myriad of senses while all the equipment needed for a relaxing holiday without daily hassles have been carefully taken care of.

MASTER BATHROOM

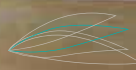



ONCE UPON A TIME,
AN ISLAND..





the pleasure of a sweet living



MAIN VILLA

LIVING AREA: 280m²
+ 80m² OF TERRACE (LIVING - DINING ROOM)

OUTDOOR DECKING: more than 350m²

- 1 Entrance
- 2 Hall
- 3 Master bedroom
- 4 Master bathroom
- 5 Bedroom 1
- 6 Bathroom 1
- 7 Bedroom 2
- 8 Bathroom 2
- 9 Covered terrace
- 10 Kitchen
- 11 Exterior kitchen
- 12 Circulation
- 13 Veranda
- 14 Covered terrace
- 15 Infinity pool
- 16 Deck

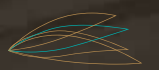

MAIN VILLA

BASEMENT: 120m²

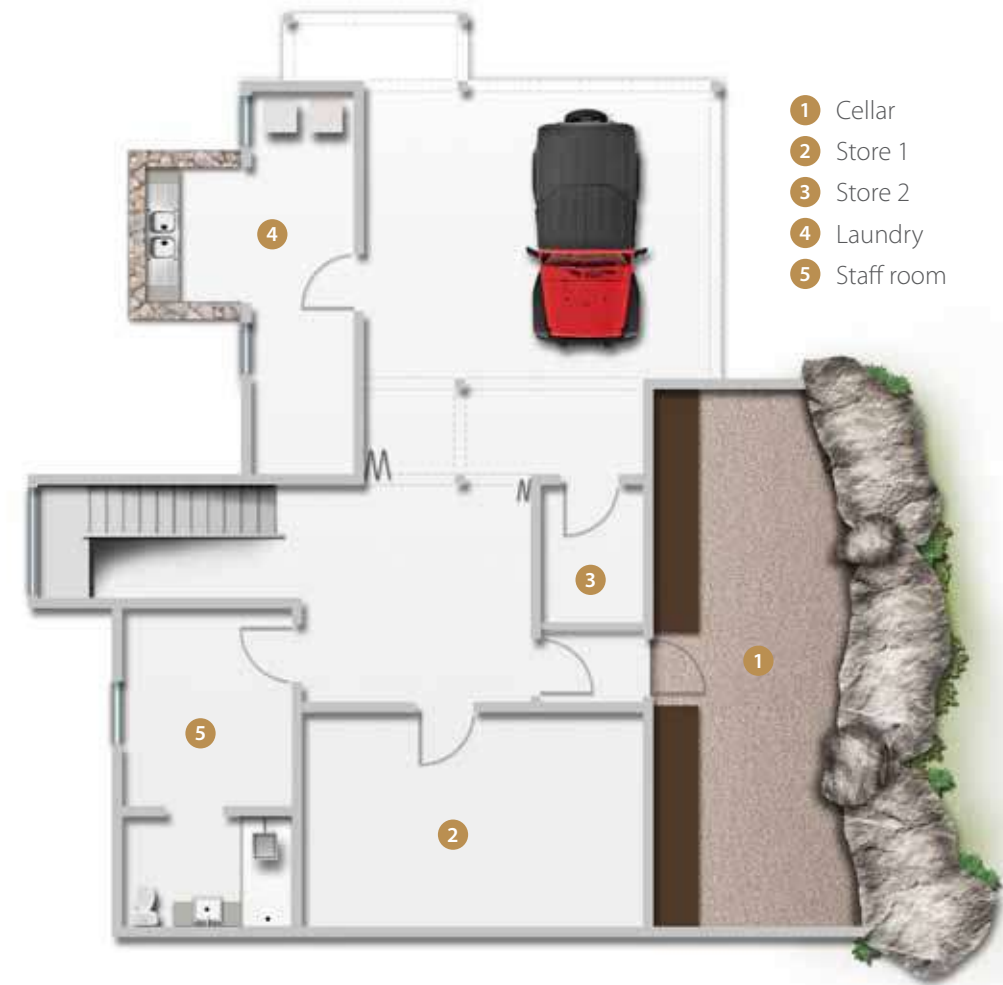

MEZZANINE

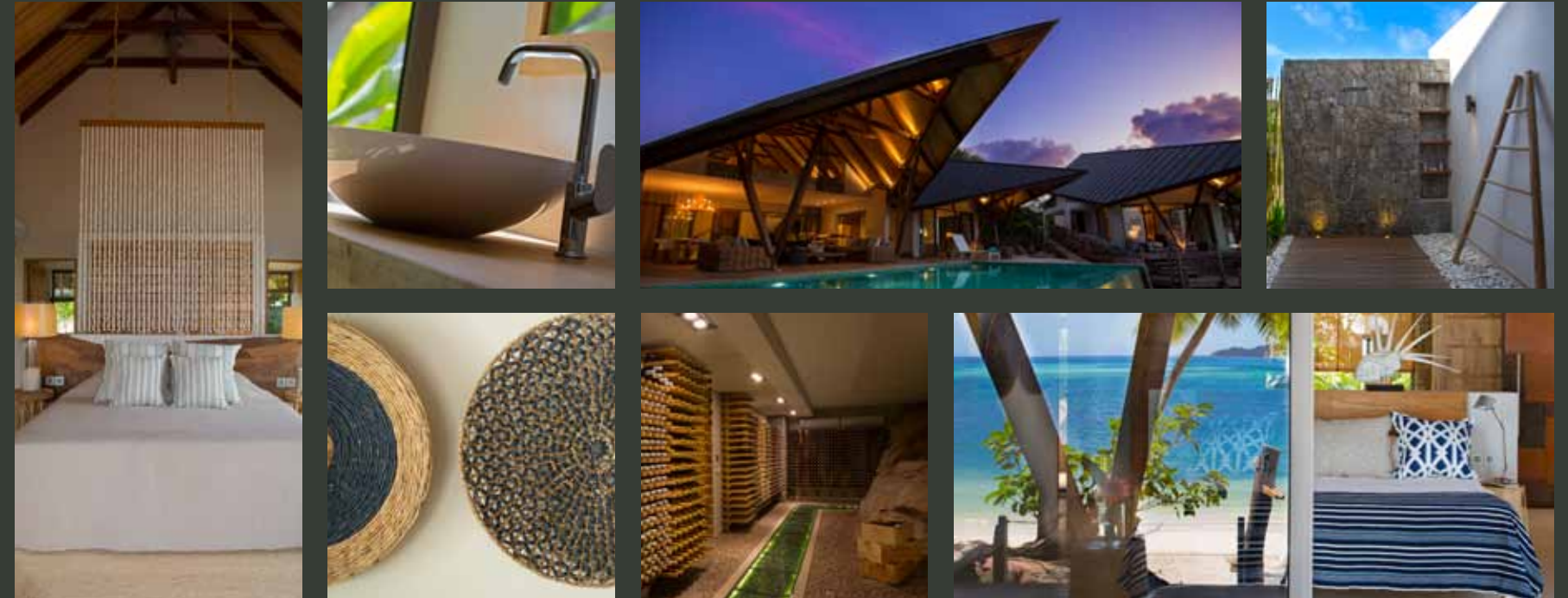

elegance, freshness and sensuality

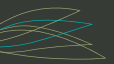

GUEST HOUSE 1

LIVING AREA: 58m²

- 1 Entrance
- 2 Bedroom
- 3 Bathroom
- 4 Dressing
- 5 Private pool
- 6 Covered terrace



GUEST HOUSE 2

LIVING AREA: 42m²

- 1 Entrance
- 2 Bedroom
- 3 Bathroom
- 4 Dressing
- 5 Private pool
- 6 Covered terrace

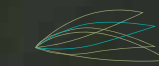



E-mail: info@deckenia.com

www.deckenia.com



