

# NOVOTEL



## Novotel Phuket Kamala Beach

A unique beachfront property on a tranquil slice of paradise





- Located directly on the shores of Kamala Beach, Phuket
- 21 kms or 30 minutes from the Phuket International Airport
- 10 minutes to Patong and 30 minutes to Phuket Town



With 166 rooms, suites and villas, this modern resort-style property is situated on a pristine 100-metre long beachfront with direct access to the turquoise waters of the Andaman Sea. Hotel facilities include one all-day-dining restaurant, a rooftop bar with spectacular sunset views, an infinity pool and swim up pool bar, an In Balance Spa & Gym, plus four multi-functional meeting rooms.

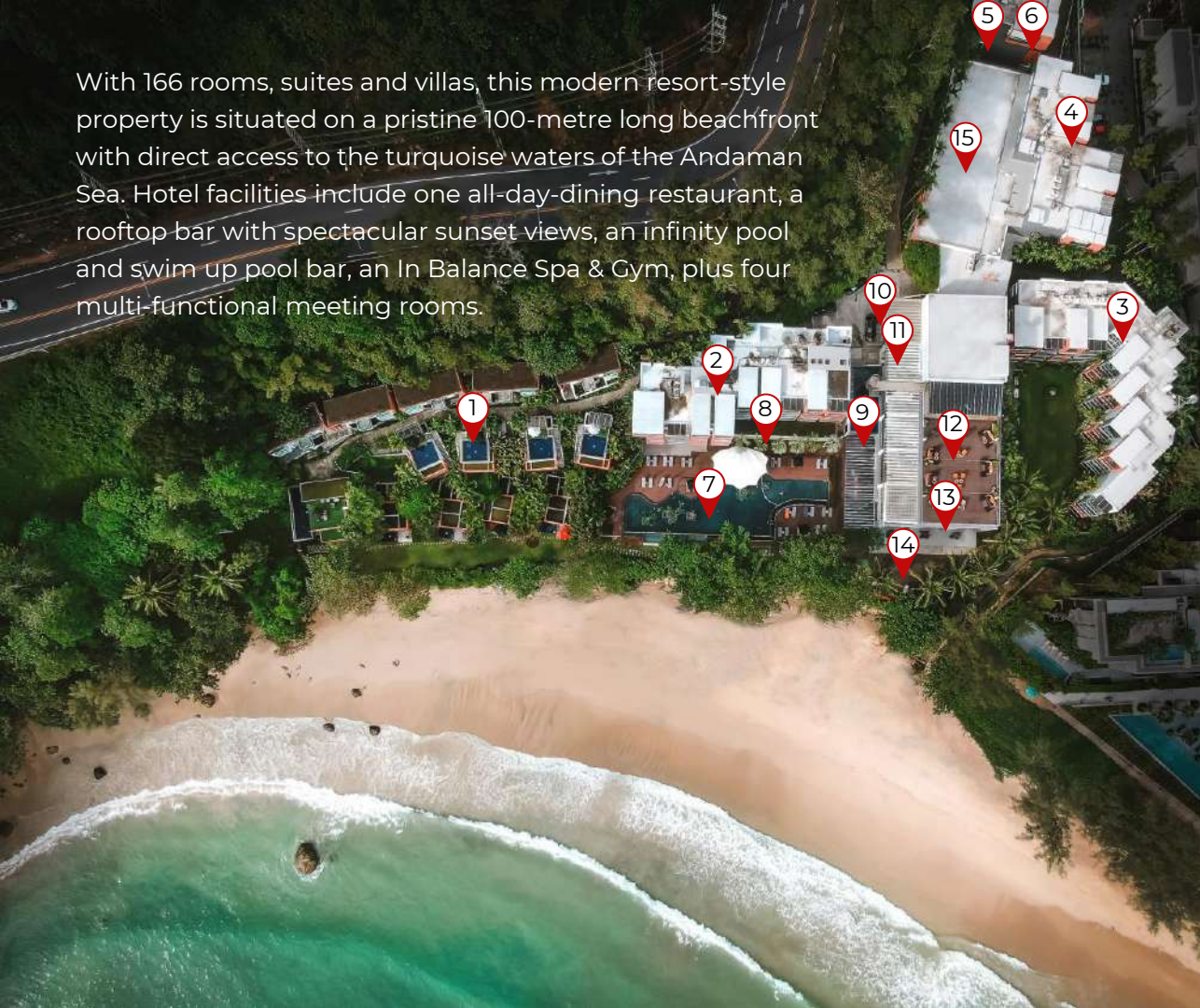

1. Villas
2. Ocean Rooms & Suites
3. Superior Garden View
4. Superior Rooms
5. Superior Rooms
6. Superior Rooms
7. Swimming Pool
8. InBalance Spa & Gym
9. Kids Club
10. Lobby
11. The Living Room, Sport Bar
12. On The Roof, Rooftop Bar
13. Soul Kitchen Restaurant
14. Verandah
15. Conference Rooms





## Total Inventory

166 rooms, including 144 Superior, 24 of these being internal connecting, with 1 reduced mobility room, along with 8 Ocean view suites and 14 Villas.

## Family

**Create lasting memories at Novotel.**

Because family time is precious, your children are Novotel's guests everywhere in the world. Children under 16 may share your room and enjoy breakfast at no extra cost. Toys and games for younger and older children are available at the Kids Club

## Room Amenities

- Free Wi-Fi throughout the entire resort
- Internet LAN cable available on request
- 42" Flatscreen LCD Television
- Complimentary tea and coffee appliances
- In room hair dryer
- In room safe deposit box
- HDMI and USB plugs to connect to the TV

## Additional for Suites & Villas

- iPod docking station
- Espresso machine with 2 complimentary coffee capsules per day



Room Type	Size (m2) Including Balcony	Private Pool (m2)	Twin	Double	Total
Superior	35	-	48	40	88
Superior Garden View	35	-	4	32	36
Ocean Room	35	-	-	20	20
Jacuzzi Villa	42	6	-	4	4
Ocean Villa	43	-	-	5	5
Ocean Suite	72	-	-	8	8
1 Bedroom Pool Villa	65	18	-	4	4
2 Bedroom Pool Villa	170	35	1	1	1

# 1\_Resort Highlights



## Direct Beachfront Access

- 14 villas just steps away from the white sands of Kamala Beach, including 4 Jacuzzi Villas located directly on the beach
- 42 rooms with breathtaking views of the Andaman Sea, including 8 suites
- Ocean views from nearly all public areas, including the hotel lobby, pool, gym and all restaurants



- Water sports available year round, including standup paddle boarding and kayaking during high season and surfing from May - October
- Just a 15 minute kayak ride to the stunning and secluded Laem Sing Beach

## Rooftop Bar & Restaurant

- One of Kamala's only rooftop restaurants, with 180 degree views of the Andaman Sea
- Ideal for sunset cocktails and social events
- Available for private functions and easily converted into a dream wedding venue



## Unique Banquet Facilities

- 250 square metre banquet room with natural light and high ceilings that can be coupled with outdoor team building activities both on the beach or in the hotel for a unique team building experience

# 2\_Rooms, Villas & Suites





## Superior

The perfect place to get some rest and relaxation in a resort location, this 30m<sup>2</sup> Superior room mixes modern decor with ergonomic comfort. Equipped with an ensuite bath and rain shower, a 5m<sup>2</sup> balcony, 42" TV and free Wi-Fi, the rooms provide everything you need when you're not lounging by the pool or enjoying a drink at On The Roof.



## Superior Garden View

Looking out over tropical landscaped gardens, the Garden View rooms come in the same configuration as the Superior room, but located in closer proximity to the beach. Available with a King bed or Twin beds.



## Ocean Room

With inspiring views of the picturesque Kamala Beach, Ocean rooms are ideal for a romantic getaway or a rejuvenating vacation . Wake up in the morning with a coffee on your private balcony and then head down to the pool just steps from your abode. At 30m<sup>2</sup>, the rooms come with an ensuite bath and rain shower, a 5m<sup>2</sup> balcony, 42" TV and free Wi-Fi.



## Ocean Villa

Pamper yourself in a private bathtub as you listen to the calming sound of crashing waves from the comfort of an Ocean Villa. With floor to ceiling glass windows, these 38m<sup>2</sup> villas come with a King size bed, 5m<sup>2</sup> balcony, rain shower and bathtub, a 42" TV and free Wi-Fi. Also included is an espresso machine with 2 free coffee capsules per day and an iPod docking station.



Whether you're a couple in search of the perfect romantic getaway, a lone traveler in need of some well deserved rest and relaxation or a blogger looking for your next Instagrammable moment, the Ocean Villa has all that you've been hoping for and more.

## Jacuzzi Villa

Experience Phuket in luxury with a 42m<sup>2</sup> Jacuzzi Villa. Situated just a stone's throw away from the sea, these villas feature a 13m<sup>2</sup> terrace with a private Jacuzzi and uninterrupted views of Kamala's finest stretch of sand.



All four villas also come with a King size bed, rain shower, 42" TV, free Wi-Fi, plus an espresso machine with 2 free coffee capsules per day and an iPod docking station.

## Ocean Suite

Enjoy uninterrupted views of the Andaman Sea from one of two balconies in this spacious 72m<sup>2</sup> Ocean Suite. With plenty of room to get comfortable and make yourself feel at home, the Ocean Suite comes with a King size bed, separate living room, ensuite bathroom and rain shower, a bathtub, two private balconies overlooking Kamala Beach, two 42" TV's and free Wi-Fi.



Also included is an espresso machine with 2 free coffee capsules per day and an iPod docking station.

## One Bedroom Pool Villa

Looking to sunbathe in the tropical Phuket climate with a little more privacy? Then the 65m<sup>2</sup> One Bedroom Pool Villa is where you'll want to be. With your own private rooftop pool and sun loungers, you'll have little reason to leave the comfort of this sea view dwelling.



Equipped with a King size bed, 12m<sup>2</sup> balcony and outdoor pool, rain shower, 42" TV, free Wi-Fi, an espresso machine with 2 free coffee capsules per day and an iPod docking station.

## Two Bedroom Pool Villa

The largest of the villas, the 170m<sup>2</sup> Two Bedroom Pool Villa provides the ultimate Phuket experience for families or groups of friends. Bask in the sun from your spacious 46m<sup>2</sup> rooftop deck while your children splash around in the rooftop pool or bring everyone down to the main floor to hang out in your 2nd pool, just steps away from the sea.



Featuring two separate rooms, one with a King size bed, the other set up as a twin, and both of which provide direct beach access. Also included are three rain showers, a 42" TV, free Wi-Fi, an espresso machine with 4 free coffee capsules per day and an iPod docking station.



# 3\_Dining



# On The Roof

A rooftop bar with unforgettable 180° views of Kamala Beach's turquoise waters, forested hills and stunning sunsets. Offering a wide selection of cocktails, local beer, wine, soft drinks, food, live entertainment and daily 2 for 1 happy hour.

Opening Hours: 16.00-23.00 Hrs.

On The  
Roof



## On The Roof (Dinner)

Maximum capacity

Dining: 70 seats

Cocktails Reception: 90 people





# SoulKitchen

## Soul Kitchen

All-day dining restaurant combining innovative international and modern Thai cuisine, plus healthy food options with fresh organic and locally-produced dishes. Seating for up to 160 people, including a large outdoor verandah where guests can enjoy a cool sea breeze during breakfast or a romantic dinner by night.

Opening Hours: 06.30 – 23.30 Hrs.

## Soul Poolside Grill

Offering a tasty selection of burgers, sandwiches, salads and local specials without ever having to leave the laid back atmosphere of our beachfront pool.

Opening Hours: 06.30 – 23.30 Hrs.

Soul **POOLSIDE**  
GRILL

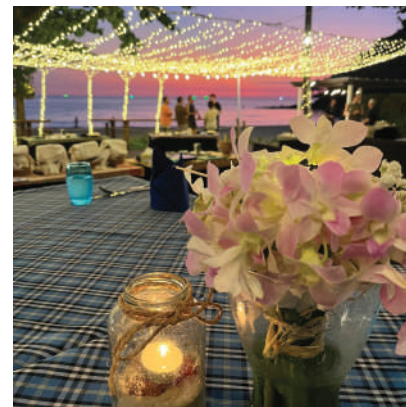

## Verandah

Maximum capacity up to 80 people





Romantic Dinner



## The Living Room Sport Bar

Set up in an open air space, The Living Room sports bar provides a cool and comfortable setting to catch all your favorite sporting action. Watch your favorite team on one of three widescreen TVs at the bar or challenge a friend to a game of pool while enjoying a variety of casual bites and a selection of both local & international beverages.

Opening Hours: 08.00 – 18.00 Hrs.







## Lilo Pool Bar

It wouldn't be a holiday without a pool by the beach and a tropical drink in hand. Swim up to Lilo pool bar, crack open a coconut and have a chat with one of our friendly bartenders. Then let loose a little and enjoy one of our signature cocktails or a selection of beer and wine.

Opening Hours: 09.00 – 18.00 Hrs.



# 4\_Hotel Facilities



A woman and a man are lying on massage tables in a spa. Two therapists in white uniforms and face masks are performing massages on their backs. The woman has a white flower in her hair. The background features a stone wall with a waterfall effect.

## In Balance Spa by Novotel

Whether you're looking for a traditional Thai massage after a long day of exploring Phuket or a full day spa package that includes multiple treatments and a private Jacuzzi, there's something to meet all needs and budgets at In Balance Spa.

Opening Hours: 10.00 – 20.00 Hrs.

**IN BALANCE**  
SPA BY NOVOTEL





## In Balance Gym

This comprehensive indoor fitness centre comes with the latest equipment, ocean views, changing rooms, lockers, showers and a steam room.

Opening Hours: 07.00 – 21.00 Hrs.

# Kid's Club

The perfect place for your kids to have some fun while you enjoy some relaxation. Filled with games & activities tailored around both education and entertainment for children, the whole family will be able to have a fulfilling holiday at Novotel Phuket Kamala Beach.

Opening Hours: 10.00 – 17.00 Hrs.

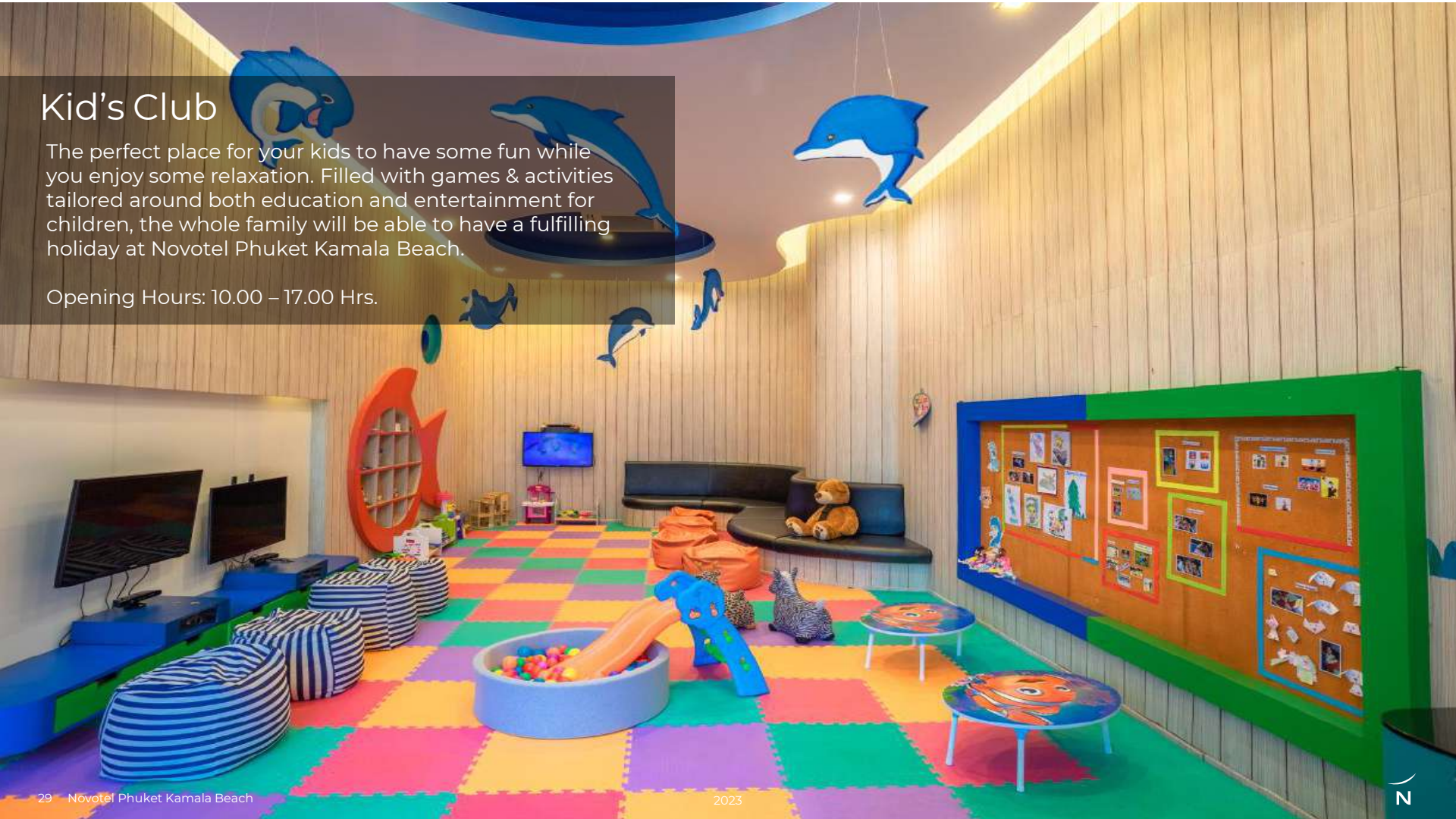

## Home Convenience

Located in Soul Kitchen, the Home Convenience shop provides Bistro St. Tropez trunks and shorts, Robin Ruth beach bags, hats, sandals, sunglasses & accessories, an assortment of drinks, chocolates & sweets, toiletries, snacks & personal care items.



# Meetings & Events

- Modern meeting rooms with natural light & high ceilings
- State-of-the-art audio-visual equipment
- Highly experienced meeting planners & service staff to ensure the flawless planning and execution of your event
- Excellent onsite food & beverage outlets, including a rooftop bar with panoramic views of Kamala Beach



FUNCTION ROOM	DIMENSION		CAPACITY						
	AREA (Sqrm)	HEIGHT (M)	THEATRE	CLASSROOM	U-SHAPE	I-SHAPE	BANQUET INCL ROUND TABLES	DINNER & DANCE FLOOR INC ROUND TABLES	COCKTAIL RECEPTION
Paradise Main Multi	250	5.5	120	90	60	50	110	90	220
Pre Function	120	5.5	-	-	-	-	-	-	100
Andaman	62	5.5	36	24	22	20	40	30	62
Kathu	62	5.5	36	24	22	20	40	30	62
Muang	62	5.5	36	24	22	20	40	30	62
Phuket	62	5.5	36	24	22	20	40	30	62

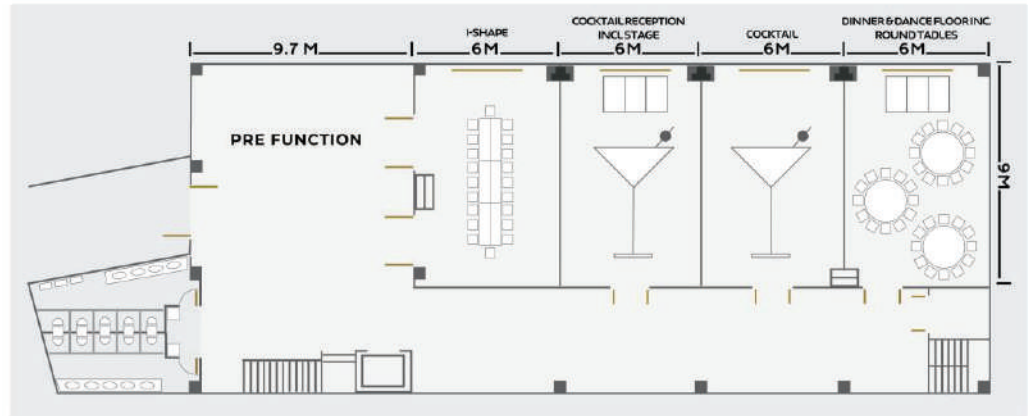







# 5\_Activities





Team Building Activities





Yoga





Kamala Beach Surfing





Daily Activities



NO  
VO  
TEL

Thank you

NOVOTEL PHUKET KAMALA BEACH

118/16 Moo 3 • Tambon Kamala • Amphur Kathu • Phuket 83150 • Thailand

Tel : +66 76 303 700 • Fax : +66 76 303 777

Email: [H7235-RE1@accor.com](mailto:H7235-RE1@accor.com) • [all.accor.com/7235](http://all.accor.com/7235)